

THE NEXT GENERATION of BASEMENT WINDOWS

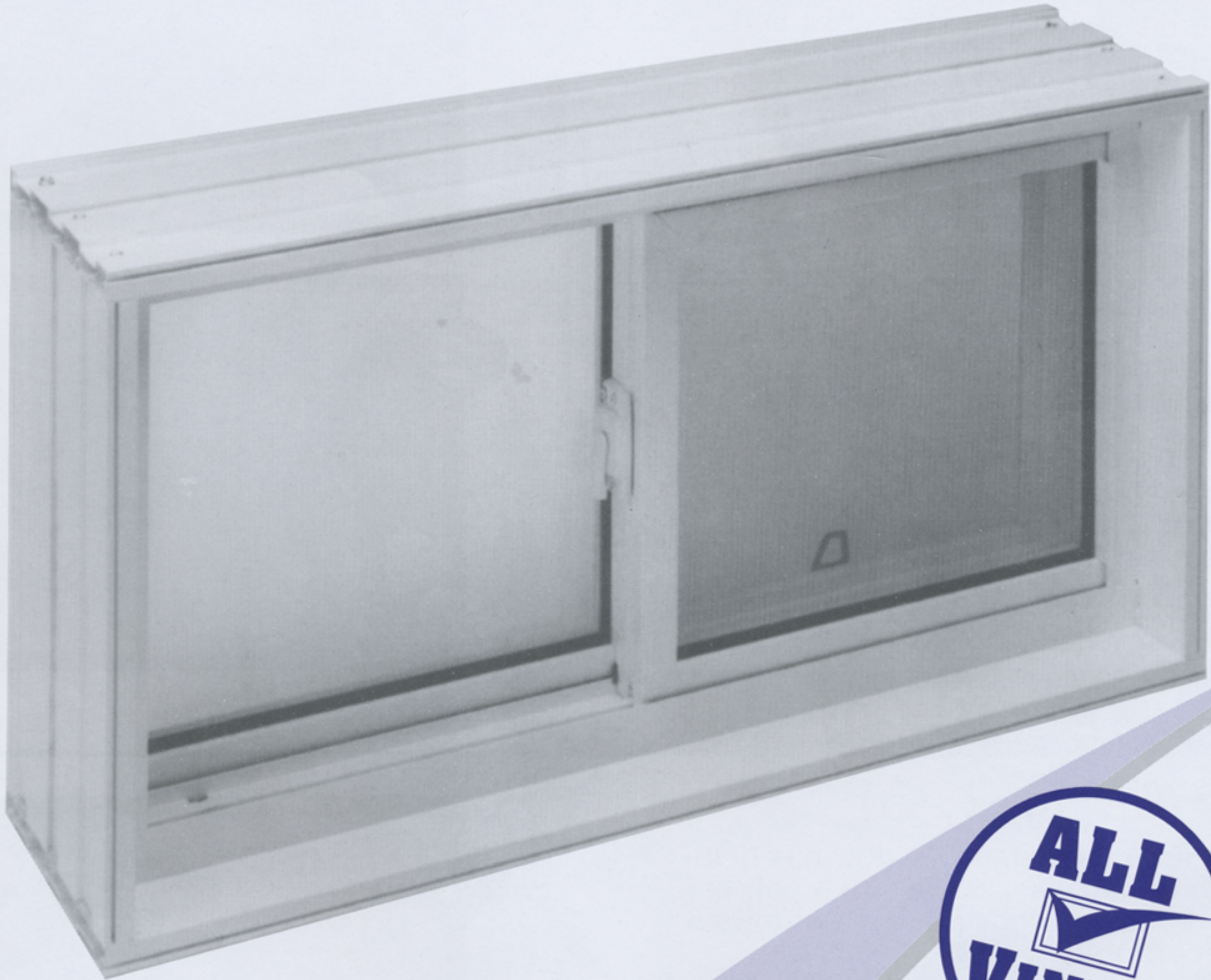

FREEDOM BASEMENT WINDOWS

PATENT 6,067,754



www.WindowsByUnlimited.com

The Bucks Stop Here!

Basement window installation has never been easier than with the **Freedom Basement Window**. Designed to fit the entire depth of foundation forms, the Freedom Basement Window is fast and easy to install without the need for pouring buck extensions or additional braces. Here's How:

- 1** Locate the Top Inside Sticker to insure proper installation.
- 2** Place the window inbetween the forms. Fasten by nailing through the forms and into the interior wood bracing in all four corners on both sides, or clamp the window into place with form clamps.
- 3** Pour the concrete. After the forms have been stripped the Freedom Basement Window is complete. Remove the protective film and wood bracing and lock your sash. No pouring bucks, no hassles, and no return trips.

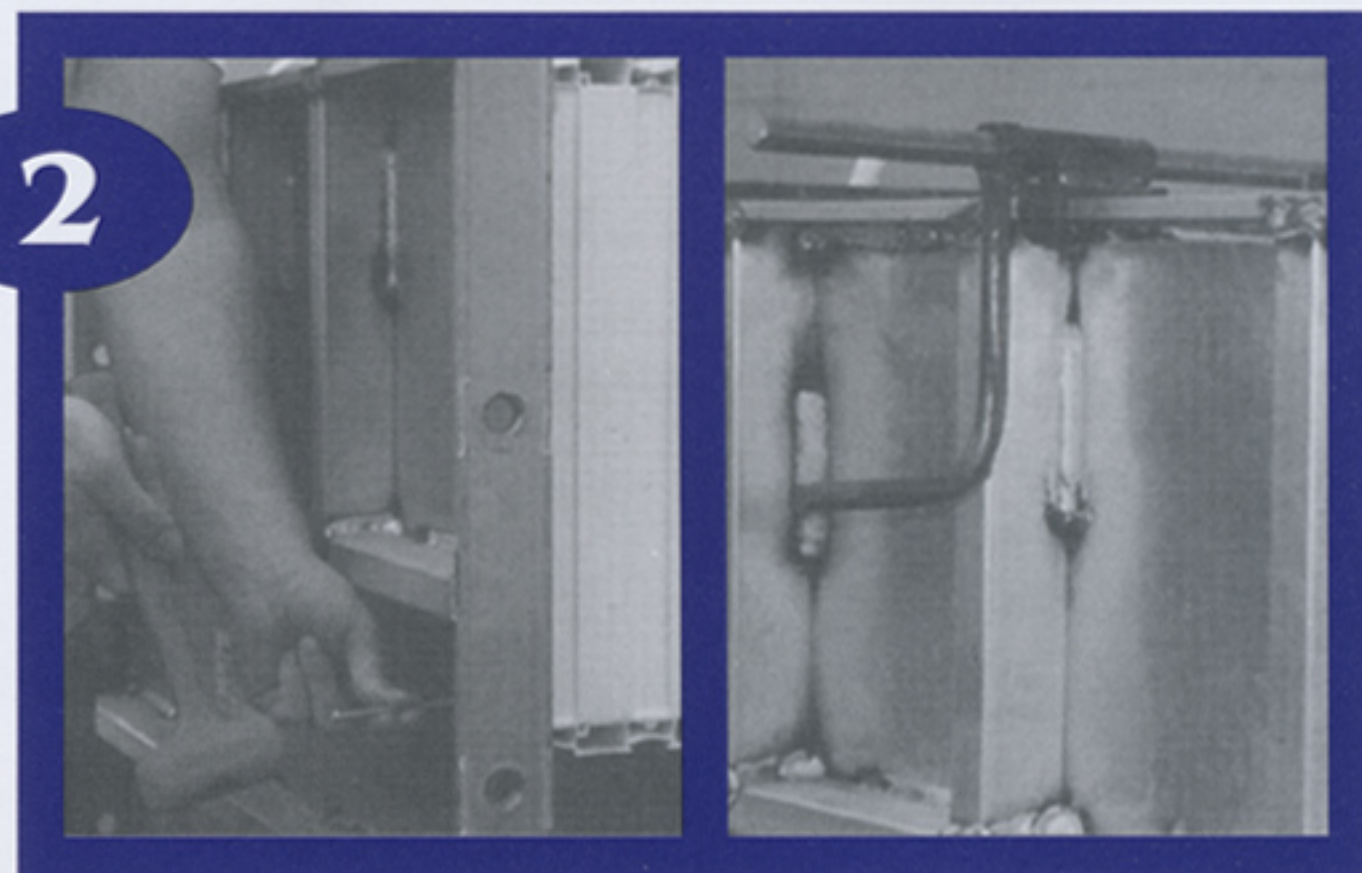
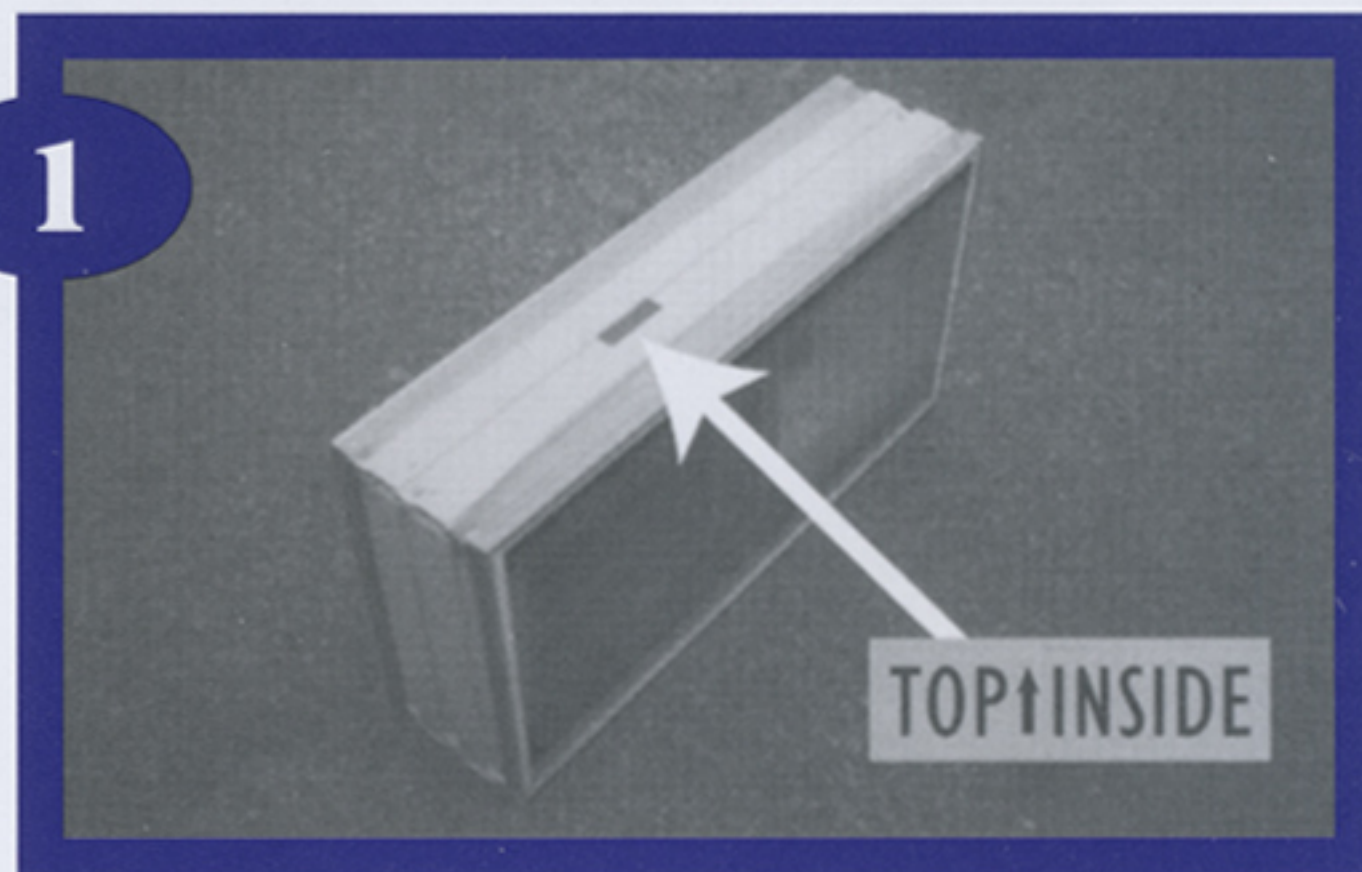

SERVICE & REPAIR

Easy As 1, 2, 3!

The Freedom Basement Window has been designed to make servicing and repair of damaged or incorrectly poured windows a snap. Incorporating a "Universal Frame", the header, sill, and jamb pieces can be removed from the frame and reversed or replaced to make a window right. Here's How:

- 1** Place a 2x4 flush against the frame resting flat against one of the jamb pieces. Using a hammer hit the 2x4 into the jamb piece until it pops out from the frame.
- 2** Repeat as necessary on the other jamb, header, and sill piece. Both jamb pieces must be removed before header and sill pieces can be removed.
- 3** Replace damaged pieces or reverse existing pieces to make the window right. make sure the screen track is toward the outside. No cutting, screwing, or gluing required - Easy as 1, 2, 3!

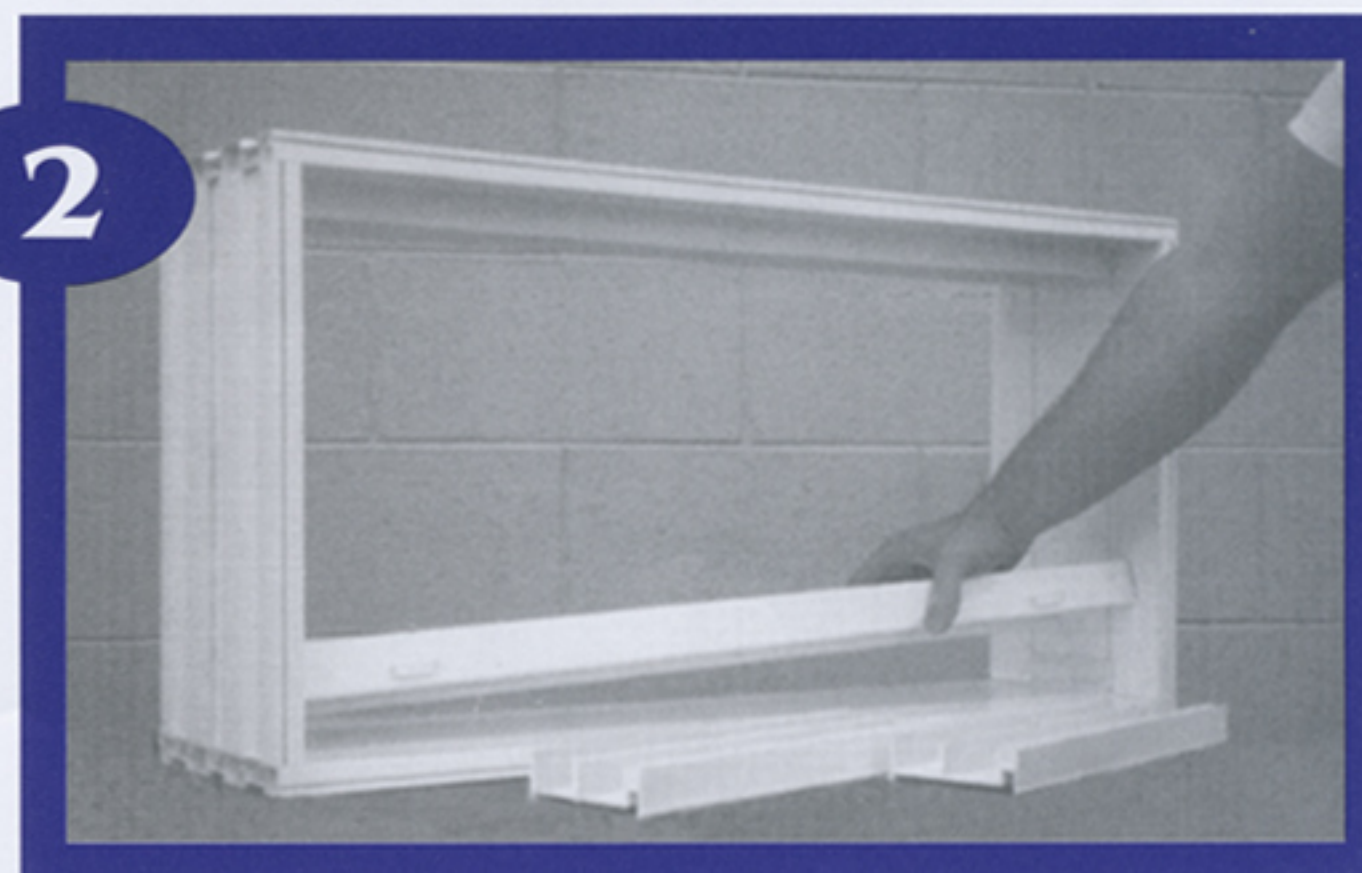



The Next Generation

A WINDOW FOR EVERY APPLICATION

The Freedom Basement Window System includes the following:

STYLES

- **Awning** - hinged at the top locks on the bottom
- **Hopper** - hinged at the bottom locks on the top
- **Slider** - 2 sliding sashes and a removable screen
- **Inswing** - sash swings in for easy egress
- **Picture Window**
An insulated glass unit surrounded by a 1³/₈" weather stripped and weeped vinyl frame.

All styles include **Low E and warm edge** insulated glass units as standard. Argon gas filling is an option. Acrylic block available as an option to the insulated glass unit.

- **Automatic Foundation Vent** opens at 70 degrees F and closes at 40 degrees F.
- **Frame Depths** for various wall thickness are 5¹/₂", 7¹/₄", 7¹/₂", 7⁷/₈"

The 2" extensions provide endless options.

• Some Popular Sizes

- 30¹/₂" x 16"
- 30¹/₂" x 20"
- 48" x 48"
- 27" x 45"

Custom sizes are also available.

- **Egress Requirements** of 20" x 24" net clear opening and 5.7 square feet can be met with the 48" x 48" slider and the 27" x 45" Inswing. Check your local and state building codes for compliance.
- **Color**
White vinyl is standard, custom color is an option.

3

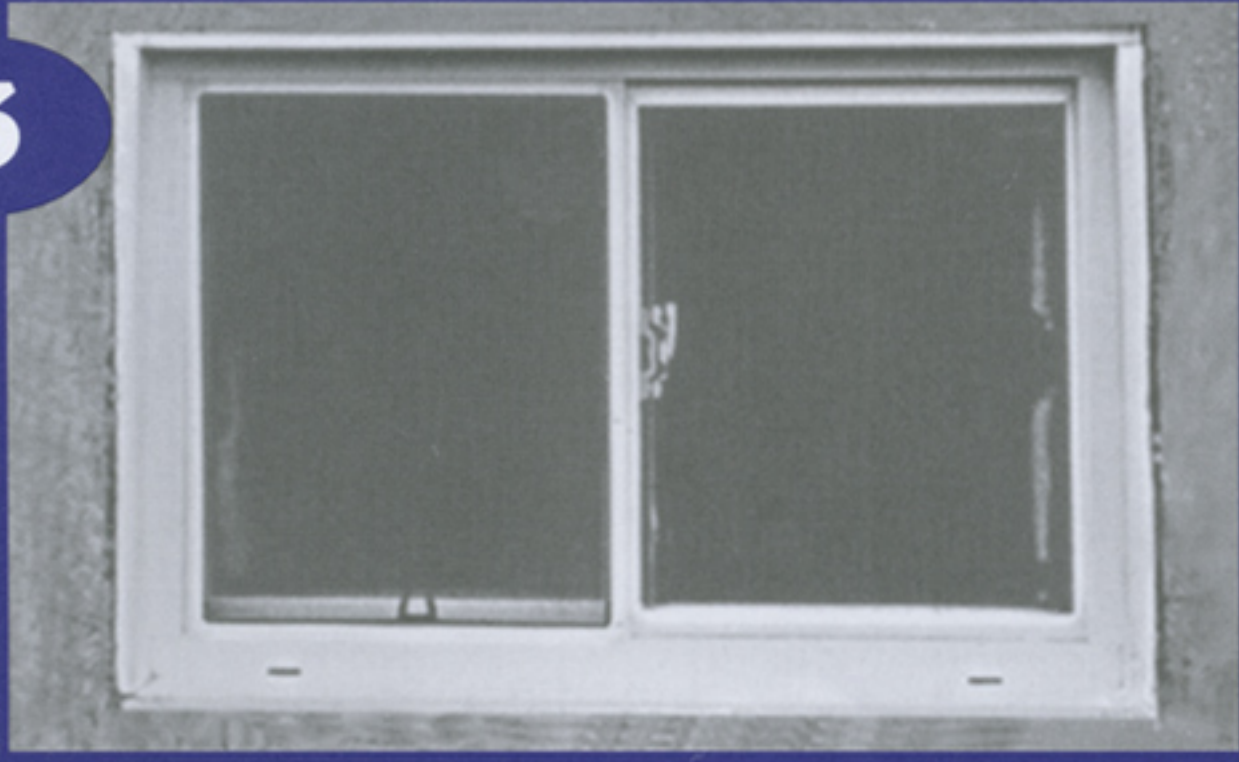

MAINTENANCE

The Freedom Basement Window offers a lifetime of service without time consuming maintenance.

To clean the vinyl use hot water and a mild soap. Follow the soap manufacturer directions for correct dilution.

To clean the glass use a conventional glass cleaner with a soft cloth or paper toweling.

Damaged glass can be replaced at your local glass shop. Specify a 5/8" overall insulated glass unit. If you experience any problems call your distributor.

3



2" EXTENSION



MORE WINDOWS - LESS INVENTORY

In the case of 10", 12" or greater walls, the Freedom Basement Window utilizes existing base frames with a 2" extension, so windows with multiple wall depths do not need to be inventoried. To make a 10", 12" or greater window, apply the 2" extension to the inside face of the window by snapping the extension into the integral snap-in groove. This can be done with a rubber mallet or hand pressure. The extension is available for both standard and custom size units and can be used with all base frames. Simply Amazing!



PREPARED FOR YOU

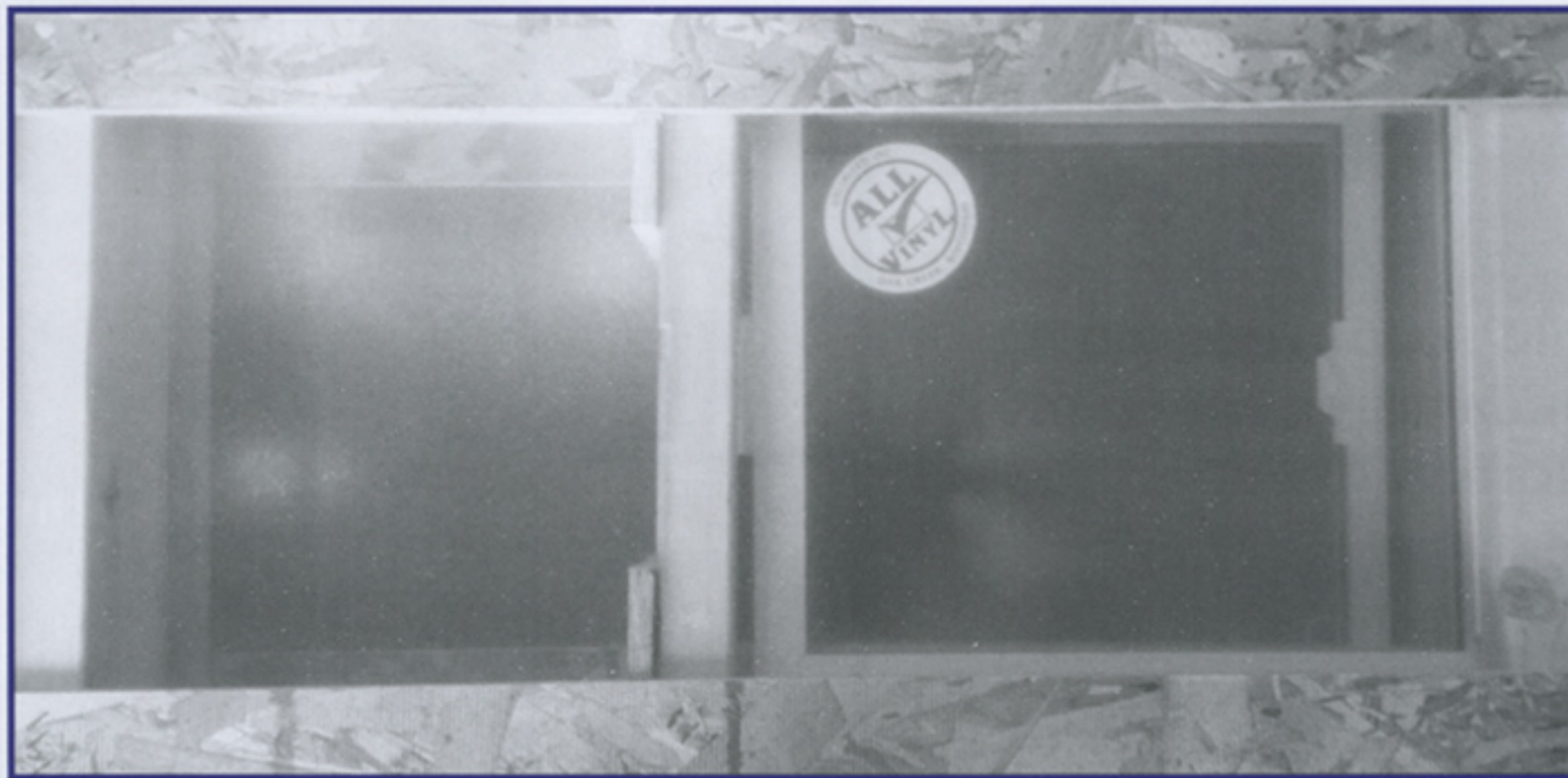

Temporary Wood Bracing

- Keeps the window square
- Provides a way to mount the window in a basement form

Plastic Film

- Keeps window clean from concrete, dirt, and spray coatings

When Used In A Poured Wall

- No need for pouring bucks, just set and pour

Removable/Replaceable

- Header, sill, and jamb pieces can be removed from the frame and replaced to quickly repair damaged or backward/upside down windows



www.WindowsByUnlimited.com

7277 S. 10th Street, Oak Creek, WI 53154

Phone (414) 764-4455 Toll Free 800-848-6213 Fax (414)764-1016